

**DECLARATION OF GEO-TECHNICAL ENGINEER:**

UNDERSIGNED HAS INSPECTED THE SITE AND CARRIED OUT SOIL INVESTIGATION THEREON. IT IS CERTIFY THAT THE EXISTING SOIL OF THE SITE IS ABLE TO CARRY THE LOAD COMING FROM THE PROPOSED CONSTRUCTION AND THE FOUNDATION SYSTEM. PROPOSED HEREIN IS SAFE AND STABLE IN ALL RESPECT FROM GEO-TECHNICAL POINT OF VIEW

*(Signature)*  
 Prasenjit Kumar Ghosh  
 Geotechnical Engineer  
 EMPANELLED NO. 61 (KMC)

**SIGNATURE OF GEO-TECHNICAL ENGG.**

**CERTIFICATE OF STRUCTURAL ENGINEER.**

THIS IS TO CERTIFY THAT THE STRUCTURAL DESIGN AND DRAWING OF BOTH FOUNDATION AND SUPER STRUCTURE OF THE BUILDING HAS BEEN MADE BY ME CONSIDERING ALL POSSIBLE LOADS INCLUDING THE SEISMIC LOAD AS PER THE NATIONAL BUILDING CODE OF INDIA AND CERTIFIED THAT IT IS SAFE AND STABLE IN ALL RESPECTS.

*(Signature)*  
**ANKIT AGARWALA**  
 B.E. CIVIL, M.E. (STR)  
 G. ENG. M.I. STRUCT. E. (LONDON)  
 Membership No. -078529819  
 KMC EMPANELLED STRUCTURAL ENGINEER  
 CLASS-1, E.S.E. 17172

**SIGNATURE OF STRUCTURAL ENGG.**

I HAVE REVIEWED / CHECKED THE STRUCTURAL DRAWING AND DESIGN DETAILS OF THIS PROJECT WHICH HAS BEEN DONE COMPLYING RELEVANT I.S. CODE INCLUDING SEISMIC AND THE NATIONAL BUILDING CODE. I CERTIFY THAT THE STRUCTURE WILL BE SAFE & STABLE AGAINST ALL VERTICAL AND LATERAL LOADS AND WILL BE SAFE FOR HABITABLE USE.

*(Signature)*  
**UTPAL SANTRA**  
 B. C. E., M. C. E. (STRUCT)  
 F. I. E. -11232801  
 KMC Empanelled Structural Engineer  
 E. S. R. - (I) 5810

**SIGN. OF STRUCTURAL REVIEWER.**

WE DO HERE BY UNDERTAKE WITH FULL RESPONSIBILITY THAT - (1) WE SHALL ENGAGE ARCHITECT & E.S.E DURING CONSTRUCTION. (2) WE SHALL FOLLOW THE INSTRUCTION OF ARCHITECT & E.S.E DURING CONSTRUCTION OF THE BUILDING (AS PER B.S PLAN). (3) K.M.C AUTHORITY WILL NOT BE RESPONSIBLE FOR STRUCTURAL STABILITY OF THE BUILDING & ADJOINING STRUCTURE. (4) IF ANY SUBMITTED DOCUMENTS ARE FOUND TO BE FAKE, THE K.M.C AUTHORITY WILL REVOKE THE SANCTION PLAN. (5) THE CONSTRUCTION OF WATER RESERVOIR AND SEPTIC TANK WILL BE UNDER THE GUIDANCE OF ARCHITECT / E.S.E.

For CHOWRINGHEE PLANNERS LLP  
 by the pen of  
**AMBA HIGHRISE (P) LTD**  
*(Signature)*  
 Director/Authorized Signatory  
 as Constituted Attorney

**SIGNATURE OF OWNER.**

I HEREBY CERTIFY THAT THE ERECTION OF BUILDING ON PREMISES NO. 54, CHOWRINGHEE ROAD, KOLKATA-700071, IS UNDER MY SUPERVISION. I ALSO CERTIFY THAT THE PROPOSED CHANGES IN LAYOUT HAS BEEN DRAWN AS PER PROVISION OF K.M.C BUILDING RULES 2009.

*(Signature)*  
**SUBIR KUMAR BASU**  
 Registered Architect  
 Regn. No. - CA778/4375

**SIGNATURE OF ARCHITECT.**

**PROJECT :**  
 REVISED PLAN OF PROPOSED ADDITION OF 2B+G+INTERMEDIATE +42 STOREY ( 190.10M ROOF HT. ) RESIDENTIAL BUILDING , U/S 394 OF KMC ACT 1980, BUILDING RULES 2009,

AT PREMISES NO 54 CHOWRINGHEE ROAD, KOLKATA - 71 (B-VII, W-63), P.S- SHAKESPEARE SARANI UNDER KOLKATA MUNICIPAL CORPORATION.

**STRUCTURAL ENGINEER**

**M.N.Consultants (Pvt).Ltd.**  
 ISO 9001:2015 CERTIFIED COMPANY  
 "M.N.C. HOUSE"  
 151/5 Rajabanga Main Road, Kolkata-107  
 Ph.no.-9133-2441808/9133-40185700  
 FAX NO. 9133-24418083  
 E-MAIL: mncomp2008@gmail.com

**ARCHITECTS:-**

**ARCHITECT HAFEEZ**  
**CONTRACTOR**

29, BANK STREET, MUMBAI 400  
 023 TEL: 2266 1920  
 AND

**Subir Kumar Basu**  
 4, Broad Street, Kolkata - 700019  
 (T) +91 33 22870333, (F) +91 33 22833043  
 (E) basu\_subirkumar@yahoo.com

**ARCHITECTURAL**

**DEMOLITION PLAN**

Drawn: <b>D.PAL</b>	Checked: <b>S. CHAKRABORTY</b>	Approved: <b>S. K. BASU</b>
------------------------	-----------------------------------	--------------------------------

SKB/ALC/CHW/TOWER/ARC/KMC/16	Sheet size & Scale: A1 & 1:150	Sheet NO. 16 OF 18
------------------------------	-----------------------------------	-----------------------

		Date 04.12.2024
--	--	--------------------

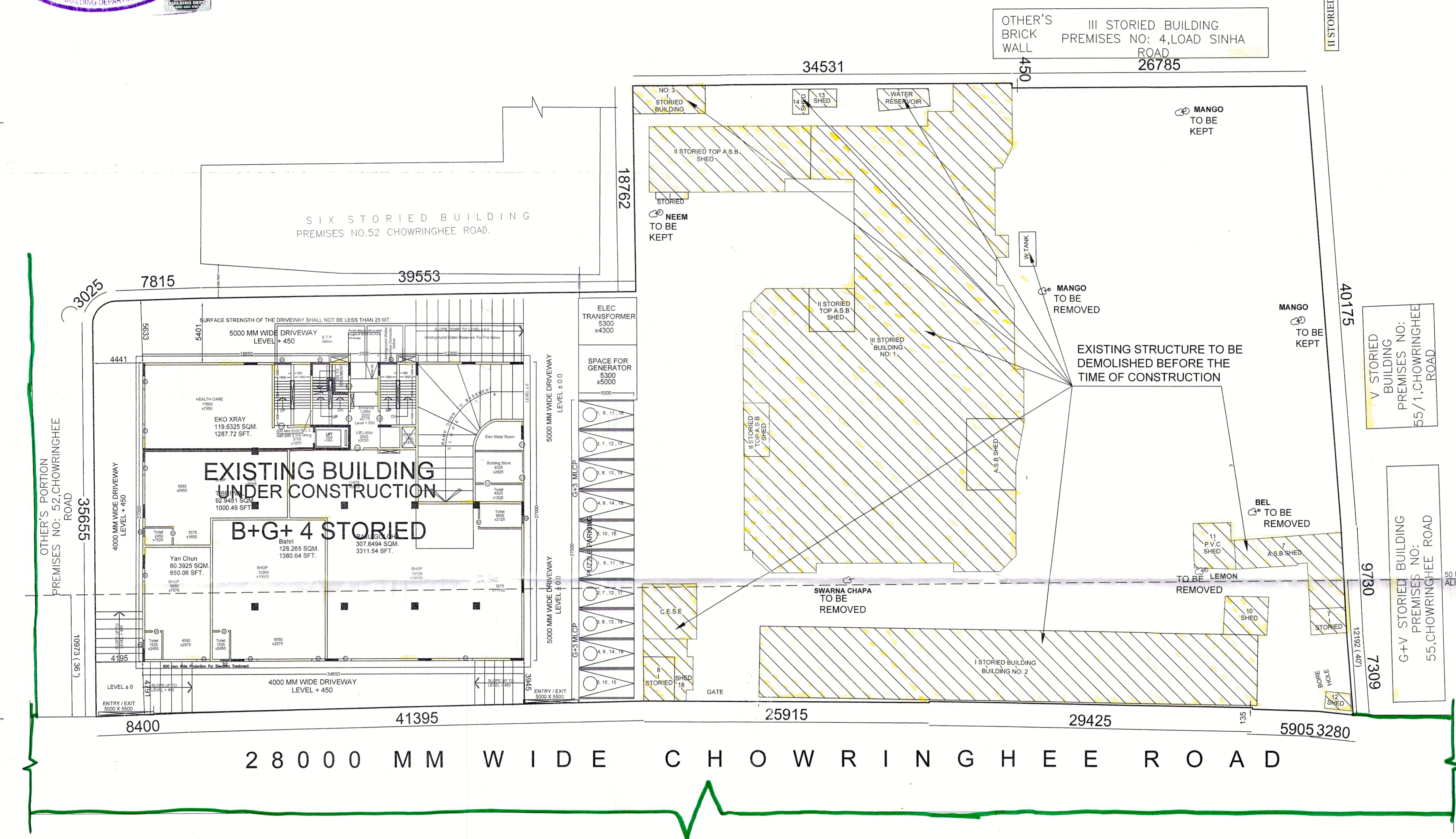

**EXISTING STRUCTURE PLAN**

# PARTY'S COPY

Plan for Water Supply arrangement including SEMILI G. & O. H. reservoirs should be submitted at the Office of the Ex-Engineer Water Supply and the sanction obtained before proceeding with the work of Water Supply any deviation may lead to disconnection/demolition.

Before starting any Construction the site must conform with the plans sanctioned and all the conditions as proposed in the plan should be fulfilled.  
The validity of the written permission to execute the work is subject to the above conditions.

No rain water pipe should be fixed or discharged on Road or Footpath.  
Drainage plan should be submitted at the Borough Executive Engineer's Office and the sanction obtained before proceeding with the drainage work.

Design of all Structural Members including that of the foundation should conform to Standards specified in the National Building Code of India.

A suitable pump has to be provided i.e. pumping unfiltered water for the distribution to the flushing cisterns and urinals in the building incase unfiltered water from street main is not available.

All Building Materials to necessary & construction should conform to standards specified in the National Building Code of India.

### DEVIATION WOULD MEAN DEMOLITION

Non Commencement of Erection/ Re-Erection within Five year will Require Fresh Application for Sanction

APPROVED AS PER RESOLUTION OF M.I.C., VIDE ITEM NO. M 56/72 DT. 07/04/2025

CONSTRUCTION SITE SHALL BE MAINTAINED FREE FROM AIR POLLUTION ACCORDING TO UNDERTAKING SUBMITTED AS PER AMENDMENT DT. 31.01.2019 VIDE NO. 95/MA/OIC-4/38-728/17 OF SCHEDULE-IV OF KMC BUILDING RULE 2009

Approved By M.C.C. Meeting No. 6484 Meeting date 06/10/25  
The Building Committee 77/11/19 - 25/1/25

THE SANCTION IS VALID UP TO 11/07/2030

APPROVED

ASSISTANT ENGINEER (C)

Approved subject to Compliance of requisition of West Bengal Fire Services, if any.



"Provision for use of solar energy in the form of solar heater and / or solar photo-cells shall be provided as required under Rule 147 of Building rules, 2009 and completion certificate will not be issued in case of building without having such provision"

CONSTRUCTION SITE SHALL BE MAINTAINED TO PREVENT MOSQ TO BREEDING AS REQUIRED U/S 496 (1) & (2) OF CMC ACT 1980. IN SUCH MANNER SO THAT ALL WATER COLLECTION & PARTICULARLY LIFT WELLS, VATS, BASEMENT CURING SITES, OPEN RECEPTACLES ETC. MUST BE EMPTIED COMPLETELY TWICE A WEEK.

The sanction refers to the proposed portion shown in red and the Executive Engineers makes no admission as to the correctness of the plan.

The building materials that will be stacked on Road/Passage or Foot-path beyond 3-months or after construction of G. Floor, whichever is earlier may be seized forthwith by the K.M.C. at the cost and risk of the owner.

### RESIDENTIAL BUILDING

OFFICE OF THE EXECUTIVE ENGINEER BUILDING BOROUGH-VII  
DATE 16/07/25  
THE KOLKATA MUNICIPAL CORPORATION